

Welcome to the latest news and information from Burgtec

Project update

We've had some great projects going through our system this year and below is just a highlight. From custom booth seating at Curtin Uni to the Heritage listed Wanslea building fitout in Cottesloe, our team sure have been kept busy.

[Click here](#) to view more images & recent projects.

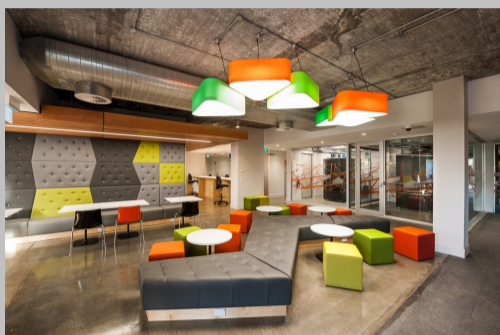

curtin uni building 501 refurb



cancer support wa



leeway group

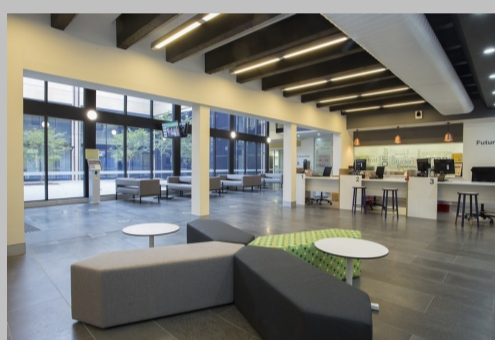

uwa student services

New product: Hi-Lo Health Station

Electronically operated sit stand desks are the ideal solution for changing your working position easily and quickly at the touch of a button. Design & engineered by Burgtec, the Hi-Lo health station is manufactured right here in WA. Our Hi-Lo system is made to order and suitable for rectangular, L-shape & 120 degree layouts to suit your specifications.

We have recently been awarded the contract for 821 desks at HBF's new head quarters as part of the Kings Square Project, and our team have been working together with Geyer developing a variation of our Hi-Lo product for this project.

More information is available on our [website](#) or click here to view the [brochure](#)



Radiant lighting design studio

We're excited to have Radiant Lighting join us at Burgtec on Hay!

Located at 993 Hay St, the showroom has been fitted out with some amazing lighting pieces & we look forward to seeing you there soon.

Open 10am - 3pm Monday - Friday

www.radiantlighting.com.au

